

Quartzlock



E10-MRX

SMAC

Lowest Cost Sub-Miniature Atomic Clock



E10-MRX-OEM



Lowest Cost Sub-Miniature Atomic Clock

Specifications	
Output	10MHz Sine, 7~13dBm (HCOMS option)
Harmonics	<-40dBc
Accuracy	$\pm 5E^{-11}$ at shipment @25°C
Short Term Stability (AVAR)	8E ⁻¹¹ /1s 3E ⁻¹¹ /10s 8E ⁻¹² /100s
Drift	5E ⁻¹² /day 5E ⁻¹¹ /month
Phase to Noise (SSB)	
1Hz	
10Hz	-95dBc
100Hz	-125dBc
1kHz	-135dBc
Input Power	6W at 12V @ 25°C, Max 1.5A
Input Voltage Range	+12V~+15Vdc
Warm Up	5 minutes to lock @ 25°C
Retrace	$\leq \pm 2E^{-11}$
Magnetic field sensitivity, dc (± 2 GAUSS)	$< \pm 4E^{-11}$ /GAUSS
Frequency Control	$> 5E^{-9}$ (External trim range: 0V~5V)
External Trim Range	$\geq 5E^{-9}$ (0V~5V)
Size	50.8x50.8x25 (mm ³) (65cc)
Weight	<150gm
Warranty	24 months
Environmental Specifications	
Operating Temp Range	-20°C~+50°C
Base Plate Temperature	-30°C~+85°C
Case Temperature	<45°C (after 1 hour, ambient temp 25°C. no ventilation)
Temperature Coefficient (ambient)	2E ⁻¹⁰ (0~50°C)
Storage Temperature	-40°C~+70°C
MTBF	100,000 hours
Environmental health	RoHS
Shock/vibration	GR-CORE-63, 4.5.2/4, locked to 1.0g
EMI	Compliant to FCC Part 15 Class B

OUTLINE DIMENSIONS

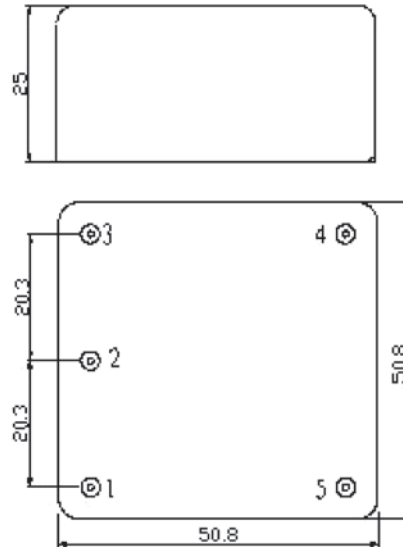

CONNECTOR INTERFACE

5 Pins match standard OCXO configurations

- Pin 1: Input frequency control
- Pin 2: Lock monitor
- Pin 3: Output signal
- Pin 4: Ground (signal & supply)
- Pin 5: Input supply (+)



Contact us:

Telephone: +44(0)1803 862062

Fax: +44(0)1803 867962

e-mail: sales@quartzlock.com

Web: quartzlock.com